



2.54mm IC Socket

MATERIAL

Insulator : Polyester
 Contact Pin : Phosphor Bronze / Brass

SPECIFICATION

Current Rate : 1 AMP
 Insulation Resistance : 5000MΩMin. at DC 500V
 Contact Resistance : 20mΩMax. at DC 100mA
 Operation Temperature : -40°C to +105°C



Detail Dimensions

Stamp Pin

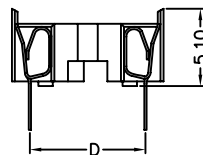
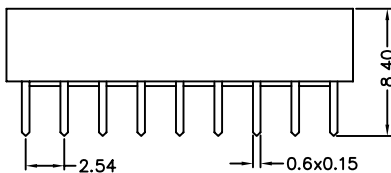
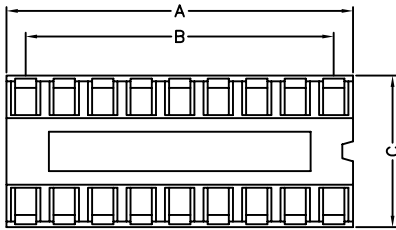

Machine Pin

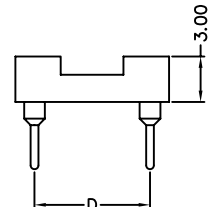
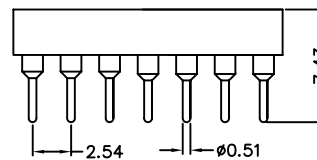
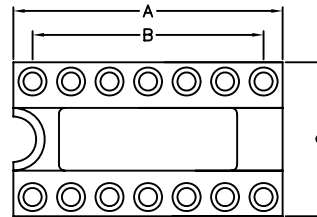

Recommended P.C.B Layout

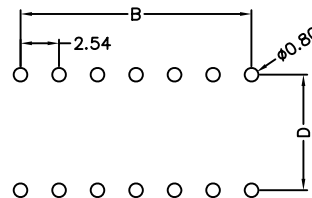
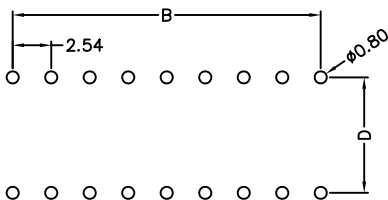

Order Information

980-x 2 - x xx x 0 x
 1 2 3 4 5 6

- 1: Stamp Pin
- 2: Machine Pin
2. Row Spacing (0.3", 0.6", 0.9")
3. No. of contacts
4. 2: w/o Bar
- 3: with Bar
5. 0: Standard Plating
6. Pinrex internal code

Standard Parts	Type
980-12-xxx205	w/o Bar
980-12-xxx305	with Bar
980-22-xxx204	w/o Bar
980-22-xxx304	w/o Bar

Number Of Contacts

Unit: mm																																		
Poles	A	B	C	D	Poles	A	B	C	D	Poles	A	B	C	D	Poles	A	B	C	D															
*306	7.62	5.08	10.00	7.62	324	30.48	27.94	10.00	7.62	648	60.96	58.42	17.50	15.24	*306	7.62	5.08	10.16	7.62	324	30.48	27.94	10.16	7.62	624	60.48	27.94	17.78	15.24	650	63.50	60.96	17.78	15.24
*308	10.16	7.62	10.00	7.62	328	35.56	33.02	10.00	7.62	664	66.16	63.62	17.50	15.24	*308	10.16	7.62	10.16	7.62	328	35.56	33.02	10.16	7.62	628	61.16	33.02	17.78	15.24	652	63.50	60.96	17.78	15.24
*314	17.78	15.24	10.00	7.62	332	40.64	38.10	10.00	7.62	+ only with bar					*310	12.70	10.16	10.16	7.62	420	25.40	22.86	12.70	10.16	632	40.64	38.10	17.78	15.24	950	63.50	60.96	25.40	22.86
*316	20.32	17.78	10.00	7.62	*624	30.48	17.50	17.50	15.24	+ only without bar					*314	17.78	15.24	10.16	7.62	422	27.90	25.40	12.70	10.16	636	45.72	43.18	17.78	15.24	952	66.04	63.50	25.40	22.86
*318	22.86	20.32	10.00	7.62	*628	35.56	33.02	17.50	15.24						*316	20.32	17.78	10.16	7.62	424	30.48	27.94	12.70	10.16	640	50.80	48.26	17.78	15.24	964	61.28	58.74	25.40	22.86
*320	25.40	22.86	10.00	7.62	*632	40.64	38.10	17.50	15.24						*318	22.86	20.32	10.16	7.62	426	35.56	33.02	12.70	10.16	642	53.34	50.80	17.78	15.24	+ only with bar				
*322	27.94	25.40	10.00	7.62	640	50.80	48.26	17.50	15.24						*320	25.40	22.86	10.16	7.62	432	40.64	38.10	12.70	10.16	648	60.96	58.42	17.78	15.24	+ only without bar				